



CARRIERES DU HAINAUT

**AZ GROENINGE
PRIDES ITSELF ON A
BELGIAN BLUESTONE
INTERIOR**

THE PROJECT IN A NUTSHELL

- AZ Groeninge hospital in Courtrai
- Built between **2005 and 2017**
- Architectural firms **OSAR Architects** (Antwerp) & **Baumschlager Eberle** (Vaduz)
- **7,131 m²** of sawn Belgian Bluestone tiles from Carrières du Hainaut (floors and walls)
- Supplied and processed by **Beltrami Natural Stone** from Harelbeke



The new **AZ Groeninge** hospital in Courtrai is the result of a merger between three former Catholic clinics and an OCMW (public social welfare) hospital. Construction of this brand-new hospital, located on President Kennedy Lane, started in 2005. The design is the brainchild of **Baumschlager Eberle** from Vaduz in Liechtenstein and **OSAR Architects** from Antwerp. Both renowned architectural firms, they opted to clad the new hospital's interior in **Belgian Bluestone** from the Carrières du Hainaut quarry.

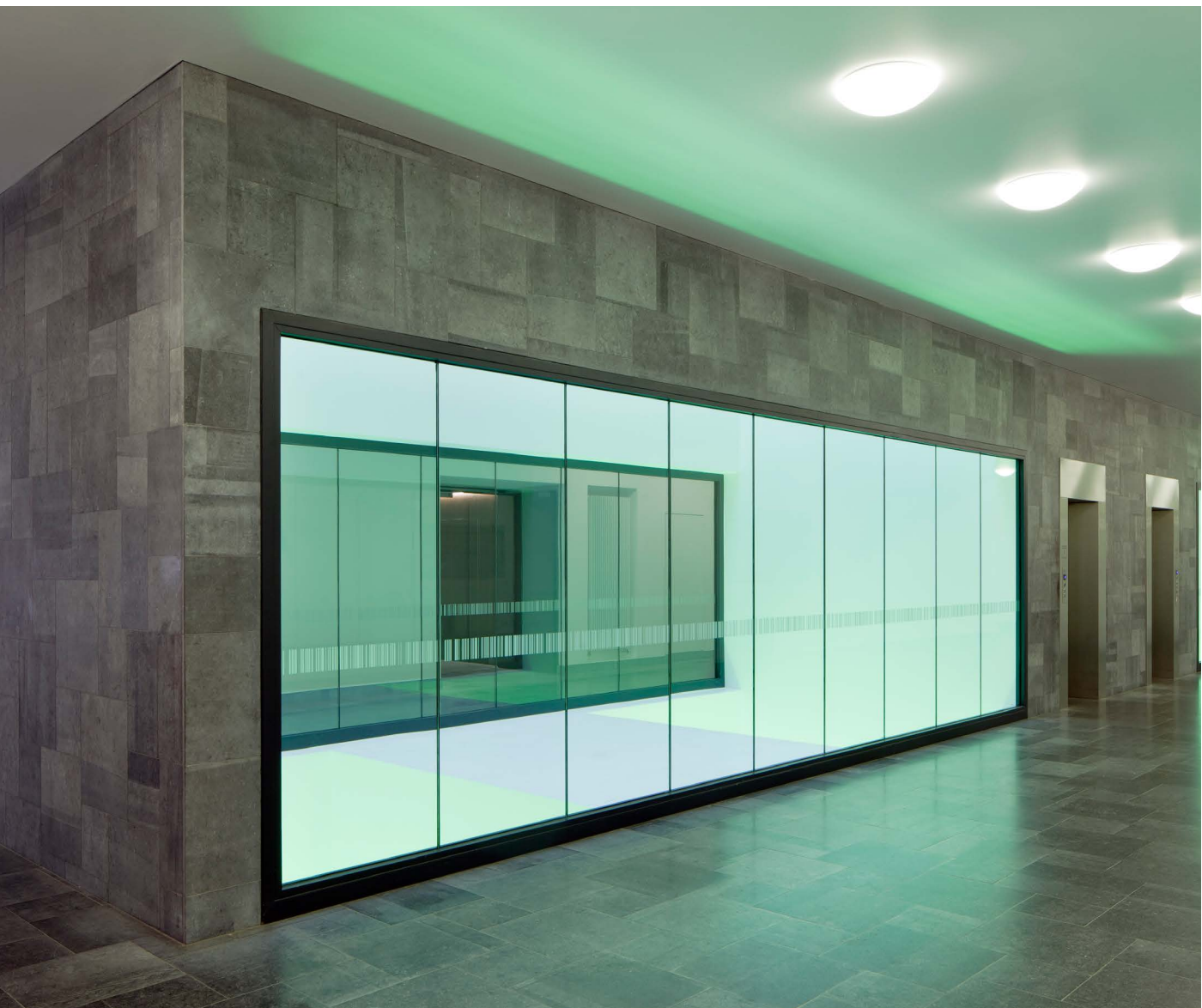

SMALL CITY



AZ Groeninge spans no less than 144,000 m² and consists of **five blocks** which are interconnected and open onto a courtyard. A considerable amount of space around the buildings was purposely left untouched and will soon be filled with greenery. The new hospital's interior covers a total of 100,000 m² and accommodates 1,051 beds. The many different spaces include twenty operating theaters, an emergency department, an additional intensive care department and four bunkers for radiotherapy. A total of 2,750 employees, 250 doctors and nearly 200 volunteers work on campus, so calling the new hospital a small city of its own is no exaggeration. Construction was carried out in two phases, the first of which ran from 2005 to 2010 and the second from 2012 to 2017. The total cost for this mega project was **119 million euros**.



AZ GROENINGE IN NUMBERS

119.000.000

total cost: 119 million euros

2,750

employees

20

operating
theaters

5

blocks

100.000 M²

on a 144.000 m² terrain

1,051

beds

2005 - 2017

built between 2005 and 2017

THAT HOMELY FEELING



Remarkably, the AZ Groeninge hospital has **only four floor levels**, one of which is located underground. The architects wanted to create an **open structure** that would make patients feel right at ease, and succeeded. The **large windows** they specified for every room offer lovely views on the hospital's park-like surroundings.

In addition to the architecture of the hospital creating an open atmosphere, the interior evokes a homely feeling. **Belgian Bluestone from Carrières du Hainaut** clads both the floors and walls in the corridors, at the reception and in other public areas. A typical Belgian, traditional and sustainable material, bluestone offers numerous advantages in hospital environments.





LOOKING GOOD

Belgian Bluestone from Hainaut scores highly in the **aesthetics** department and becomes even more beautiful over the years. It's an ideal material for a construction set to be built in multiple stages, as the last tile will look no different than the first.

The Carrières du Hainaut tiles' **diamond-sawn finish**, supplied and installed by Beltrami Natuursteen from Harelbeke, ensures clean lines and a stunning appearance. Placed in a so-called Roman pattern, the tiles display an **interesting color mix** of light and dark blue-grey.



SUSTAINABLE AND HYGIENIC

Moreover, Bluestone from Hainaut meets all the **strict requirements** hospitals have in terms of hygiene and maintenance. Floors tiled with this natural stone are resistant to **heavy foot traffic** and will never crack under the load of beds and medical materials.



Another determining factor in choosing Belgian BlueStone was **sustainability**, Belgian Bluestone having a much smaller ecological footprint than Asian types of natural stone. Compared to ceramic alternatives, its footprint is even up to sixty times smaller. Transport costs were kept to an absolute minimum as well, as the stone only had to be moved from the quarry in Soignies to the yard in Courtrai. Finally, the architects can rest assured that the stone they specified for their projected was sourced in an **ethical and safe** manner.





THE BENEFITS OF BELGIAN BLUESTONE

- Unparalleled appearance
- Ages slowly and beautifully
- Numerous creative options
- Hygienic and maintenance-friendly
- Resistant to intensive loads
- Sustainable
- Fast delivery





CARRIERES DU HAINAUT

Rue de Cognebeau, 245
B-7060 Soignies
Belgium

 +32 (0)67 34 78 00

 info@carrieresduhainaut.com
architecte@carrieresduhainaut.com

 www.carrieresduhainaut.com

 [/CarrieresduHainaut](https://www.facebook.com/CarrieresduHainaut)

 [/carrieresduhainaut](https://www.instagram.com/carrieresduhainaut)

 [/CarrDuHainaut](https://twitter.com/CarrDuHainaut)

 [/CarrDuHainaut](https://www.pinterest.com/CarrDuHainaut)